

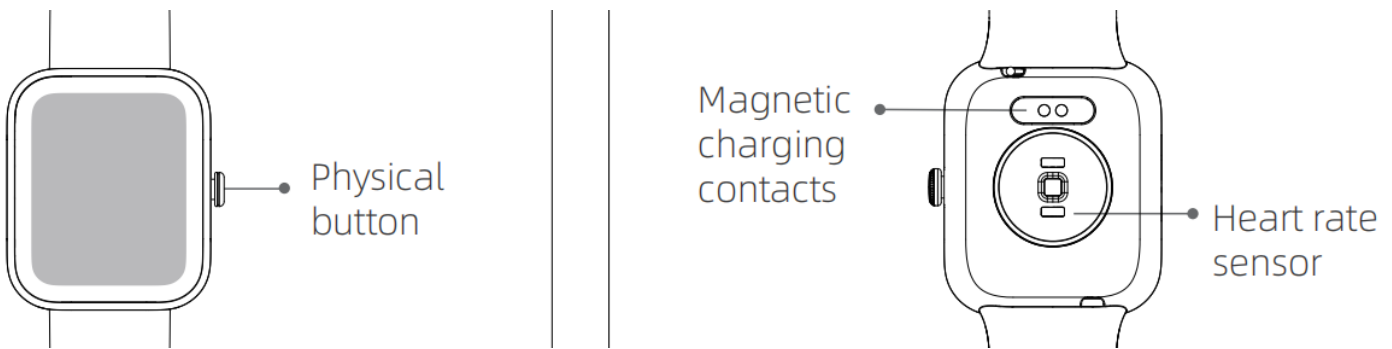

Thank you for purchasing the **Sami** wearable WS-2377. Read the instructions carefully to obtain optimum results and preserve it for future reference.

DESCRIPTION OF THE WEARABLE.



CONTENTS.

Wearable, USB magnetic charging cable, instruction manual.

CHARGING.

Connect the device to a computer or laptop with the USB Magnetic cable for charging. Put in contact the magnetic end of the USB cable with the charging points positioned in the back of your device. Kindly use only the USB cable included with the wearable. If you use a power adapter for charging, the output of the power adapter should be 5V, 1A. Charging time: **1-2** hours approx. Please charge the device fully before using it. Take care with the magnet side of the cable, if you connect to the AC and you have contact with a metal surface, you may damage the charging cable.

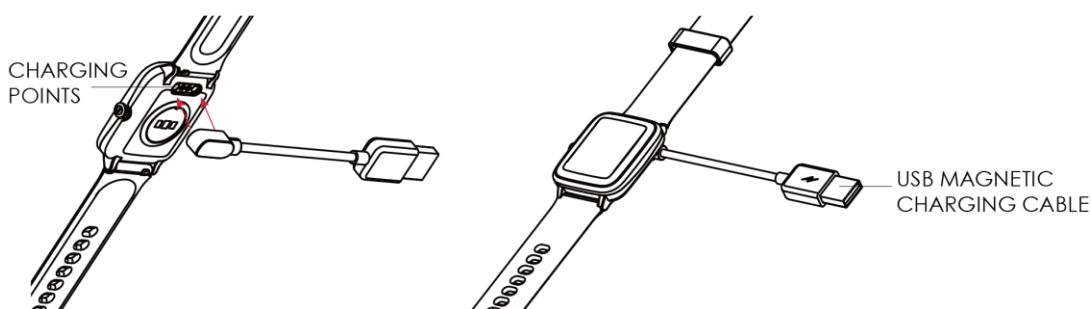

HOW TO POWER ON / POWER OFF?

- 1) To turn ON the smart band, long press the side button for a few seconds. The side button is situated in the right of the of the screen.
- 2) To turn OFF the smart band, while the device is in the home screen menu, one click the side button to enter in general menu. Then slide on the screen from down to up until you reach the icon of Setting. Click on that and than click on General, tap in the icon Power off and confirm to shutdown to make it power off.

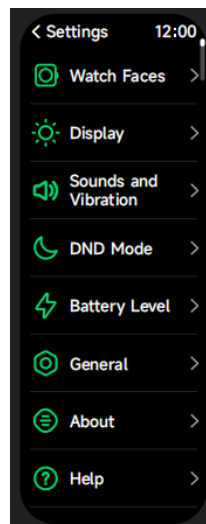

HOW TO CONTROL?

This device is equipped with a full touch display screen, it supports full screen touch control and a side button

BUTTON PRESS

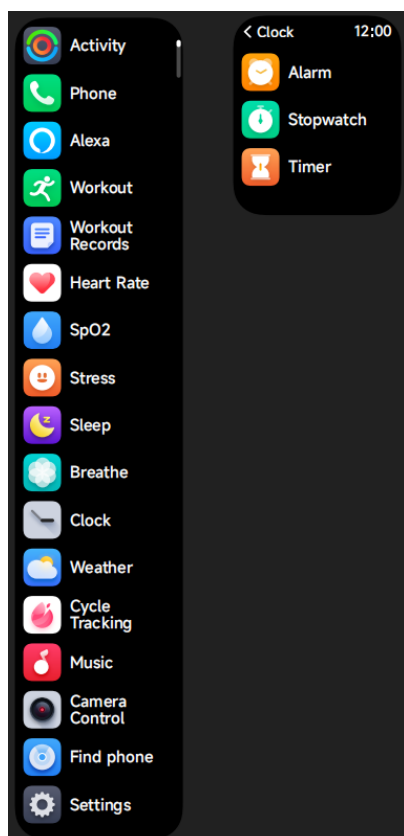

- 1) Short tap in the icon to select/enter in that menu. Slide from top/bottom to go to the next/previous page. Long press on the selected icon to enter or short press the side button to return to the previous interface.
- 2) In the home page, long press the screen for a few seconds until the screen zooms out, then slide the screen up or down and select the digital clock style you prefer to change it.
- 3) You can download and install more dials on the dial market by the app.

GETTING STARTED:

- For Android

1) How to obtain the BT Connection APK (**VeryFit**)

Search for the **VeryFit APP** in the Play Store; download it and install it in your Android smartphone, or go to our **website www.sami.es** and download the application.

2) Installation of the **VeryFit** APK.

When installing the **VeryFit** application on your Android, you must allow all the Application Permissions, allow this **VeryFit** app auto run.

The first time you run this **VeryFit app**, it will ask you to Enable Notifications, please tap OK and tap the **VeryFit** and confirm OK. You must tap OK/Allow/Pair/Yes/Confirm for any pop-up request. On your Android permission management, allow all application permissions.

3) How to make the wearable pair with your Android smart phone?

*First, turn on the Bluetooth of your Phone.

*Second, run the **VeryFit** app on your Phone, on the home page of **VeryFit**, find the pairing request by the setting all your values requested and then select "**watch**". You must have the screen of the watch on and the APP will search for new Bluetooth device(s), when the available Bluetooth device displays, please select **WS-2377** (the BT name of this device). Select the device on the app to make it pair. Select "**confirm tick**" on the watch and the pairing will be finished in a few seconds. When you pair for the first time, the **VeryFit** app will ask you to enable GPS and Bluetooth, and authorize **VeryFit** to get access to the location service while using the app. Please accept all the requests for the correct functioning of the device. When you finish select OK/Confirm/Allow for any pop-up request.

4) In the case that on the watch you have the QR CODE on the screen, then in the APP **VeryFit** click the icon of scan on the top left of the menu and scan the qr code of the watch with the camera.

Important: To enable all notifications of different softwares such as WhatsApp, Facebook, Skype, Twitter, you will need to turn on the notifications on the APP manually. On the **VeryFit** homepage, select the icon "**Device**" (situated on the right bottom of the screen), → select "**WS-2377**" → select "**message notification**" → turn on "**Allow notification**" and turn on all the APP notifications you want to active. To confirm you must click on the ✓ icon located on the top right.

THIS IS A NEW ERA SINGLE CONNECTION WATCH, IT WILL CONNECT THE BT CALL DIRECTLY ON YOUR BLUETOOTH MENU SETTINGS.

- For iPhone

1) How to obtain the BT Connection APP (**VeryFit**)

Search for the **VeryFit APP** in the APP Store; download it and install it in your iOS smartphone

2) Installation of the **VeryFit** APP.

When installing the **VeryFit** application on your iOS, you must allow all the Application Permissions, allow this **VeryFit** app auto run.

The first time you run this **VeryFit app**, it will ask you to Enable Notifications, please tap OK and tap the **VeryFit** and confirm OK. You must tap OK/Allow/Pair/Yes/Confirm for any pop-up request. On your Android permission management, allow all application permissions.

3) How to make the wearable pair with your Android smart phone?

*First, turn on the Bluetooth of your Phone.

*Second, run the **VeryFit** app on your Phone, on the home page of **VeryFit**, find the pairing request by the setting all your values requested and then select "**watch**". You must have the screen of the watch on and the APP will search for new Bluetooth device(s), when the available Bluetooth device displays, please select **WS-2377** (the BT name of this device). Select the device on the app to make it pair. Select "**confirm tick**" on the watch and the pairing will be finished in a few seconds. When you pair for the first time, the **VeryFit** app will ask you to enable GPS and Bluetooth, and authorize **VeryFit** to get access to the location service while using the app. Please accept all the requests for the correct functioning of the device. When you finish select OK/Confirm/Allow for any pop-up request.

4) In the case that on the watch you have the QR CODE on the screen, then in the APP **VeryFit** click the icon of scan on the top left of the menu and scan the qr code of the watch with the camera.

* Now you can start using your desired functions of the smart band.

Important: To enable all notifications of different softwares such as WhatsApp, Facebook, Skype, Twitter, you will need to turn on the notifications on the APP manually. On the **VeryFit** homepage, select the icon "**Device**" (situated on the right bottom of the screen), → select "**WS-2377**" → select "**message notification**" → turn on "**Allow notification**" and turn on all the APP notifications you want to active. To confirm you must click on the icon ✓ located on the top right
THIS IS A NEW ERA SINGLE CONNECTION WATCH, IT WILL CONNECT THE BT CALL DIRECTLY ON YOUR BLUETOOTH MENU SETTINGS.

PRODUCT FEATURES

BLUETOOTH (BLE 5.3)

TOUCH SCREEN. IPS TFT LCD 1.80" full touch screen with Panda glass

BUILT IN VIBRATING MOTOR

BUILT IN HEART RATE SENSOR

BUILT IN GRAVITY SENSOR

GESTURE CONTROL TO LIGHT UP THE DISPLAY SCREEN

BUILT IN BLUETOOTH CALL FUNCTION WITH HD DSP CLEAR AUDIO

BUILT IN ALEXA VOICE ASSISTANT

- 1) Time/Date/Battery displaying
- 2) Activity:

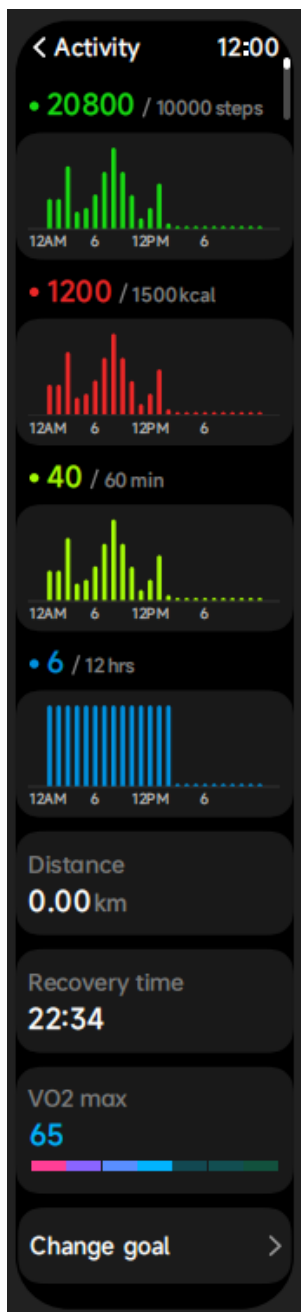

This watch can collect and display all your activity: Exercise/Activity/Walking data and goals of the day, histogram of Exercise/Activity/Walking data per hour throughout the day, Steps and Distance of the day, Recovery Time and Maximal Oxygen Uptake for the latest Exercise, Daily Goal Setting, etc.

- 3) Sports – over 90 different sport modes including Outdoor Run/Indoor Run/Outdoor walk/Indoor walk /Hiking/Outdoor cycle/Cricket/Yoga/Indoor cycle/Workout/ Rower/Elliptical.

Enter to the sports mode by selecting the sports icon, → select the sport type → enter the sports countdown automatically. During sports, to pause sports short press the side button, and to restore sports short press the side button again. To end up sports long press the icon on the screen and confirm end.

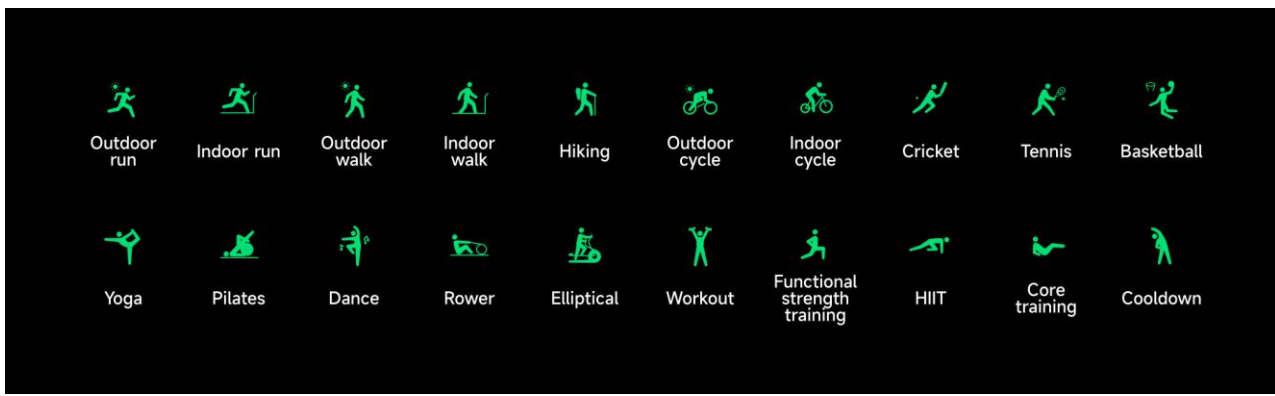

This device supports intelligent exercise recognition. It can recognize whether the user is running/walking. It supports automatically pausing an exercise or reminding when an exercise ends. This feature can be turned on/off on the app.

4) Exercise record

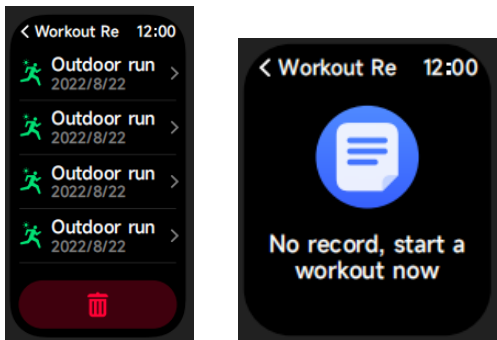

5) Heart Rate

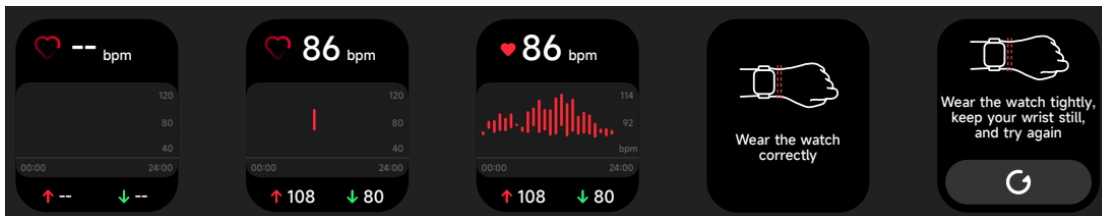

1. You can manually measure the heart rate on the watch. In the APP settings, you can turn on/off the intelligent around-the-clock monitoring of the heart rate, or view the heart data.
2. Each time heart rate is measured, keep your arm and wrist still and wait patiently until the measurement finishes.

6) Blood oxygen

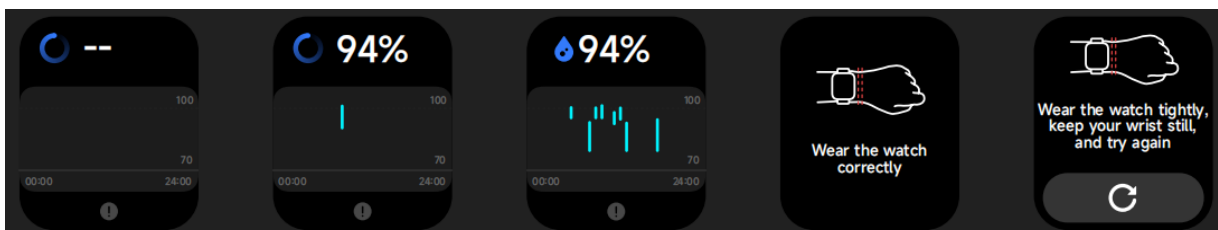

1. You can manually measure SPO2 on the watch. In addition, the watch supports automatic around-the-clock SPO2 monitoring. In the APP settings, you can turn on/off this function, or view the SPO2 data.
2. Each time blood oxygen is measured, keep your arm and wrist still and wait patiently until the measurement finishes.

7) Stress level measure

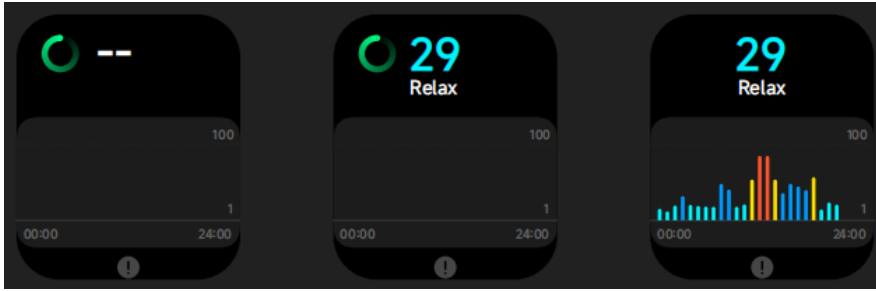

1. You can manually measure stress on the watch. In addition, the watch supports automatic around-the-clock stress monitoring. In the APP settings, you can turn on/off this function, or view the stress data.
2. Each time stress is measured, keep your arm and wrist still and wait patiently until the measurement finishes.

8) Breathe Training: Helps you regulate your breathing and relax your mood.

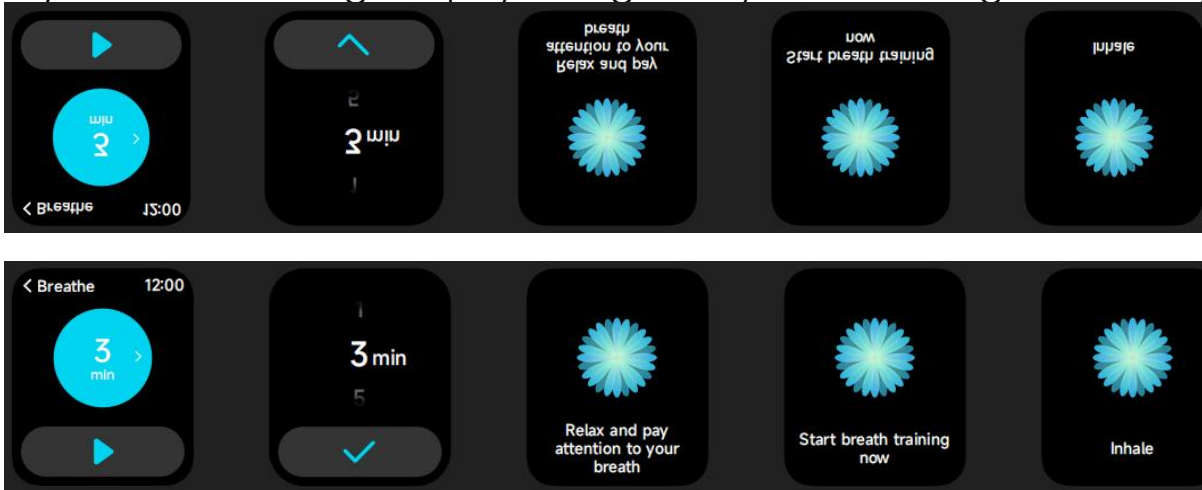

1. Click Breathe training icon to access this feature. you can choose the duration, it helps adjust your breathing;
2. Click Start to directly enter the breathe training animation. Follow the vibration and animation frequency to adjust your breathing. Reasonable breathe training can help soothe your emotions.

9) Sleep

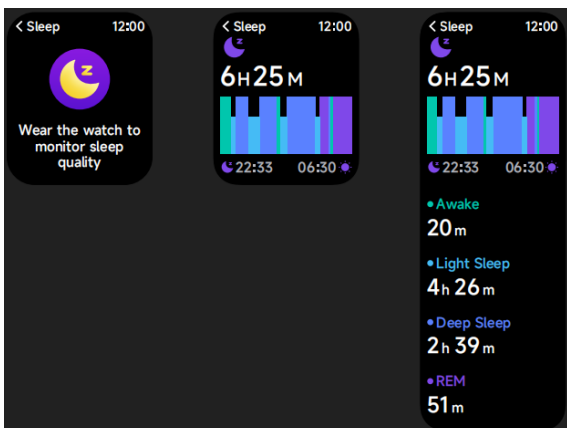

You can view the most recent sleep record and sleep status at each stage.

10) Weather forecast

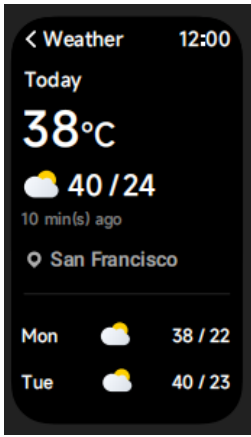

Supports Current city Three-day weather viewing, you can view today's "current weather, highest and lowest weather values" and the "highest and lowest weather values" for the next two days.

11) Music control – control music via bt on your mobile. Watch cannot playback or store music

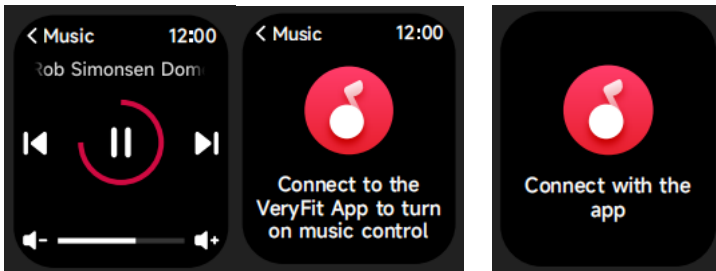

12) Stopwatch

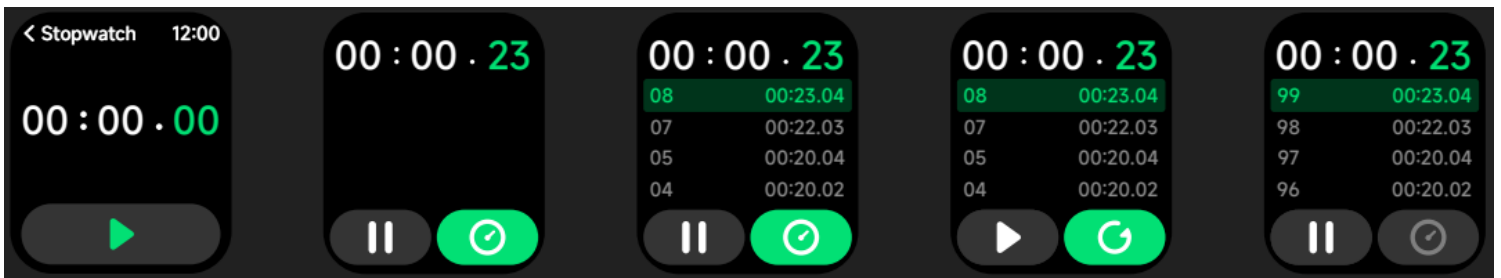

Use the watch as a stopwatch. The stopwatch has a "Lap" function.

13) Alarm Clock

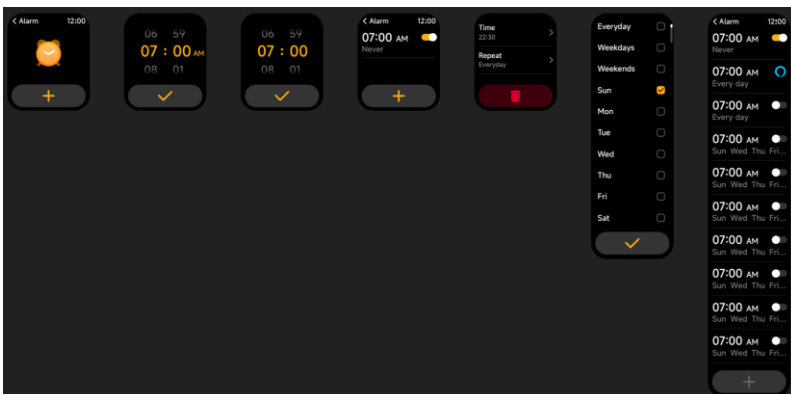

1. You can add, delete an alarm, or turn the alarm on/off on the watch, and also set an alarm for the watch via the app.
2. You can set the alarm delay time and times in the APP to decide how long you want to delay and how many times to delay.

14) Timer

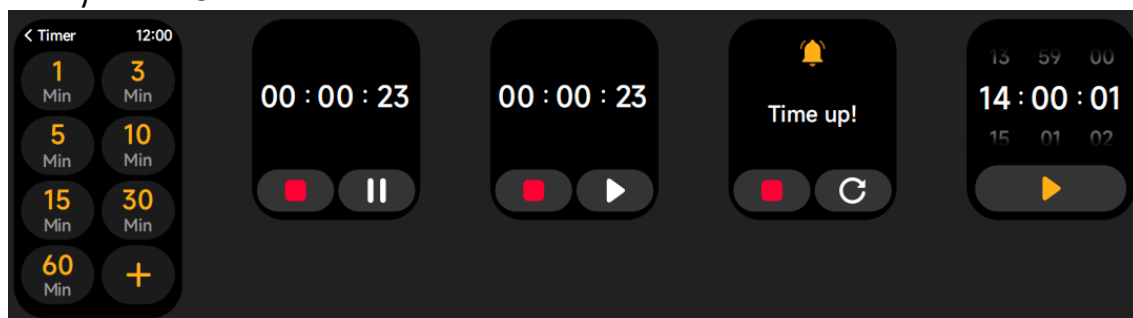

You can set a timer with a preset duration on the watch, and the timer will remind you when the timer expires; you can customize the timer time.

15) Find phone

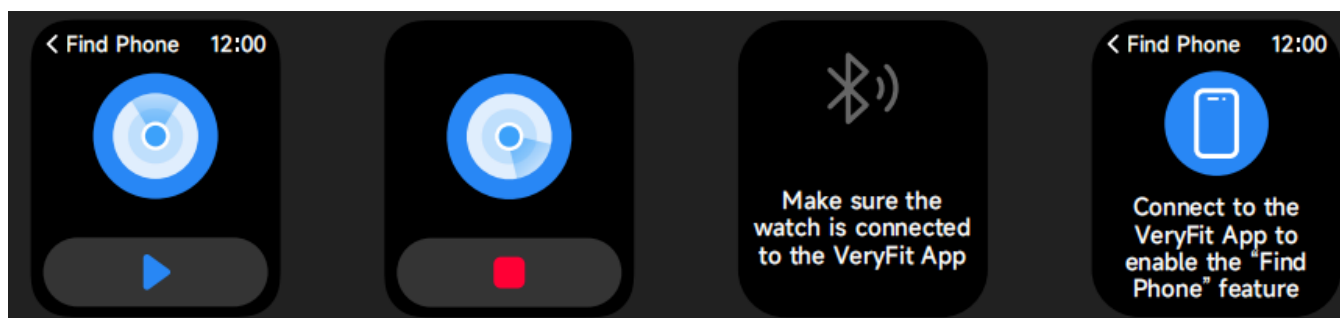

16) Settings:

1. In the watch's settings, you can set the screen-on time, ringtone volume and vibration, etc.
2. In the watch's settings, you can also shut down, restart or reset the watch (once reset, all data stored in the watch will be cleared, and the watch will be unpaired from your phone).

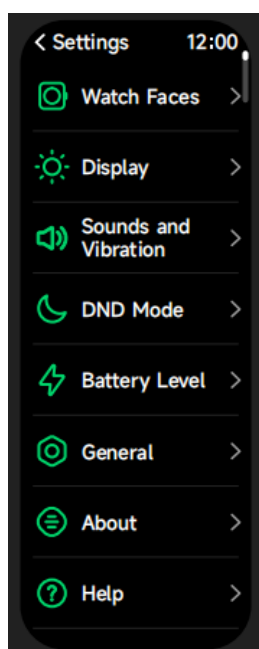

17) Reminder



The watch supports multiple reminder modes, including message reminder, incoming call reminder, walking reminder, drinking reminder, exercise goal reminder, exercise center rate warning reminder, etc

18) Control Center

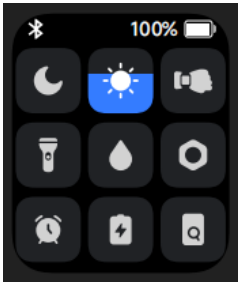

Control center gives you an easy way to turn on functions such as Do Not Disturb, raise to Wake, set the screen brightness, find my phone, turn your watch into a flashlight, etc.

19) Alexa on Veryfit app

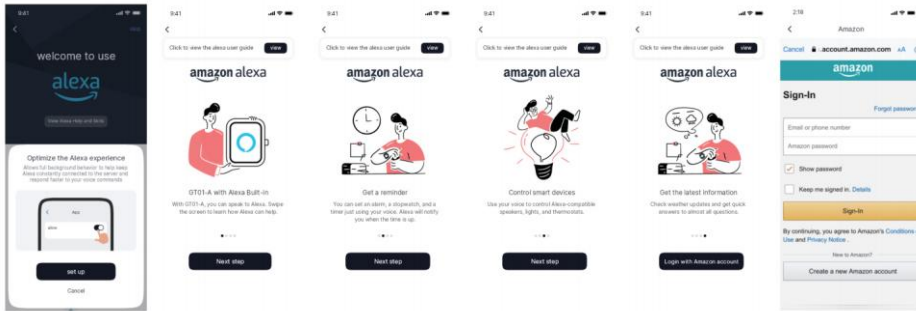

1. App can click the amazon Alexa area to enter the login tutorial interface.
2. Jump to the Amazon dedicated Alexa account login interface for account binding authorization;

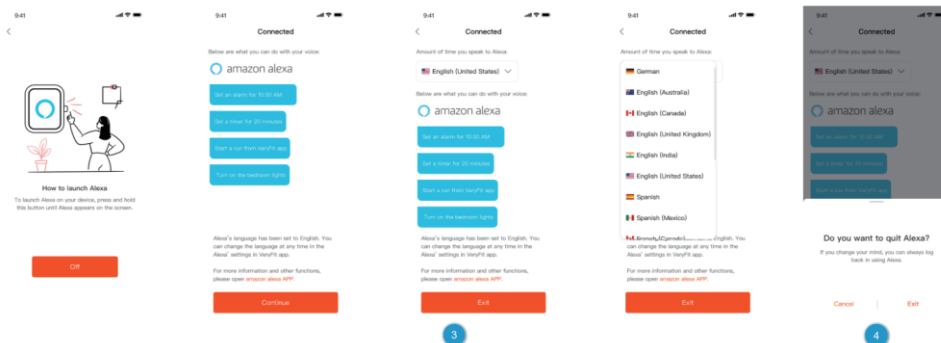

3. After binding authorization, you can view part of the operation introduction and set different national languages;

4. Click the log out button to log out of Alexa, you can log in again at any time.

20) Alexa on watch

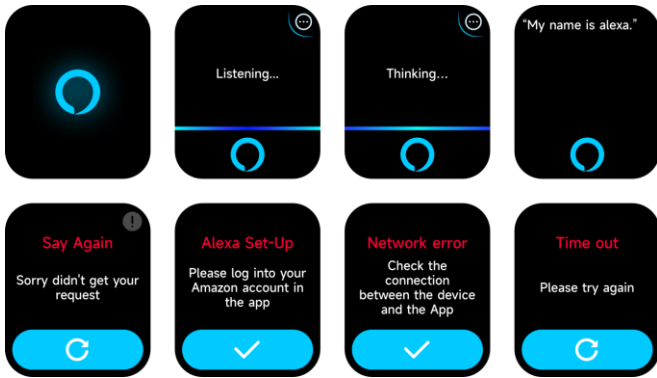

1. The watch is Alexa built-in. On Listening interface, if you ask a question or say a voice command, it turns to Thinking interface and returns an answer or executes the command. Currently via Alexa you can turn on the stopwatch, alarm clock, countdown, event reminder services on the watch.
2. A corresponding prompt is displayed in case the request is timed out, the voice is not recognized, the account is not logged in, the network connection is unstable, or the Bluetooth is not connected.

21) Phone

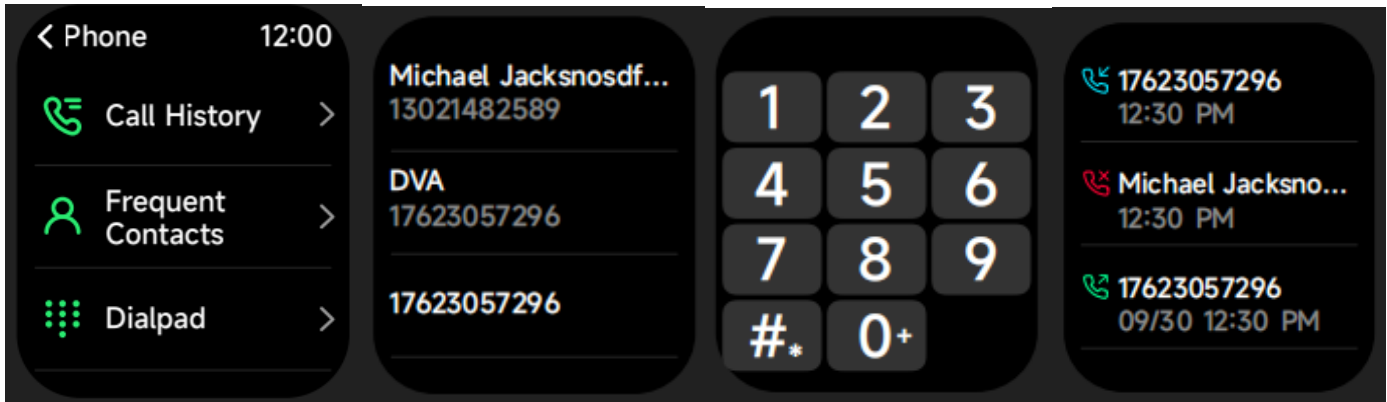

1. You can add up to 10 frequent contacts to your watch through the app, then call these contacts on your watch.
2. You can view recent call history on your watch and call the numbers displayed in the call history.
3. You can make calls through the watch's dialer.

Data can be sync from the wearable to the smart phone on the **VeryFit** APK/APP.

Your smart phone will synchronize when the Bluetooth is paired with this device.

FUNCTIONS

PHONE CALL NOTIFICATION - vibrating reminder for incoming phone calls and display on screen. This function needs to be turned on manually at the **VeryFit** APK/APP.

PHONE CALL - built in HD mic and speaker, can make call from dial pad or contact list.

MESSAGE NOTIFICATION - vibrating reminder for incoming messages and display on screen, including SMS, WhatsApp, Facebook, Twitter, Skype messages, etc. This function needs to be turned on manually at the **VeryFit** APK/APP. Memory for 10 messages.

CLOCK SCREENS (Different home digital clocks) - In the home screen of the smart band, long press the screen for a few seconds to change the style of the digital clock. You can also select the cloud dials from the APK/APP

SLEEP MONITOR - supported on the watch and **VeryFit** APK/APP

ALARM CLOCK - supported on the watch and **VeryFit** APK/APP

FIND THE DEVICE (Looking for your mobile phone) supported on the **VeryFit** APK/APP

SEDENTARY REMINDER (REMINDE TO MOVE) –set it on the **VeryFit** APK/APP

Do Not Disturb Mode – set it on the **VeryFit** APK/APP

GESTURE CONTROL (Raise your hand to light up the screen).

GPS MAP TRACE: view it on the BT APP/APK **VeryFit** when you do your sports.

TECHNICAL SPECIFICATIONS:

Display screen: TFT LCD screen 1.80". Full colour touch screen

Glass: High resistant Panda glass.

Screen resolution: 240x284pixels.

Internal Memory: 64Mb Nor Flash

MCU: Nordic ATS3085L

Touch Sensor: CST716SE (hynitron)

Acceleration and gyroscopes: STK8321 (sitronix-sensortek)

Heart rate sensor: HX3690Q

Charge I/O port : USB magnetic charging cable

Battery: Built in Li-Polymer 300mAh

Stand by time: 5-8 DAYS

Working time with BT CALL: 3-5 DAYS

Bluetooth: BLE 5.3

Water-resist Rating: IP67 this is not a water proof or water resistant watch.

Weight: 37 g

Declaration of Conformity

Hereby we,

Name of manufacturer: SANTOSHI SL
Address: CALLE FELIPE ASENJO N.56
Zip code & City: 28947 - FUENLABRADA (MADRID)
Country: SPAIN

declare that this DoC is issued under our sole responsibility and that this product:

Product description: Smart Watch
Type designation(s): WS-2377
Trademark: SAMI WEARABLE

is in conformity with the relevant Union harmonization legislation:

DIRECTIVE EMC 2014/30/EU

DIRECTIVE LVD 2014/35/EU

Standard CE (RED): DIRECTIVE 2014/53/EU

Standard RoHS: 2011/65/EU: (RoHS) Restriction of Hazardous Substance.

with reference to the following standards applied:

EN 60950-1: 2006+A11:2009+A1:2010+A12:2011+A2:2013

EN 62479:2010

EN 301 489-1 V2.1.1 (2017-02)

EN 301 489-17 V3.1.1 (2017-02)

EN 300 328 V2.1.1 (2016-11)



Signature

Full name: VISHAL MIRPURI

Position: ADMINISTRATOR

Date: 09/05/2023